



Forward Thinking, High Achieving.

# WILLARD ALTERNATIVE HIGH SCHOOL PROGRAM

Our proposal addresses optimum safety, technology infrastructure and flexible spaces designed to meet educational needs of our students.



A systemwide initiative to develop schools that work smarter for our students.

MEET YOUR SMART SCHOOLS TEAM

The Willard Alternative High School team put months into this process. We appreciate the input from students, parents, staff, neighbors and the MCPS board. If you have questions or would like to get involved, we encourage you to visit [www.mcpsmt.org/willard](http://www.mcpsmt.org/willard) or contact Principal Jane Bennett at [jabennett@mcps.k12.mt.us](mailto:jabennett@mcps.k12.mt.us).

TEAM MEMBER CORE

- Chase Rasmussen, Student
- Stephanie Wing, Teacher
- Jim Sorensen, Classified
- Jane Bennett, Administrator
- Dawn Payne, Parent
- David Gray, Business/Community

21ST CENTURY NEEDS

Willard Alternative High School, constructed nearly 100 years ago, was designed for elementary students in stand-alone classrooms and does not allow for dynamic, collaborative learning environments. Aging infrastructure likewise does not support ever-evolving technology needs nor allows for redesigning or internal remodeling.

In order to address these key issues, Willard plans to “start over” with its focus on best serving its high school students and staff.

STARTING OVER, WILLARD ALTERNATIVE HIGH SCHOOL PROGRAM

Our proposal designs and constructs a “new” Willard building due to insurmountable barriers and costs of refurbishing an aged building. New facilities will give students the best chance of graduating prepared for both post-secondary education and the work force. When complete, Willard will be a smarter school in many ways, including:

- Equitable 21st century outcomes for students at highest risk of dropping out — the school of our dreams is grounded in programmatic needs of students rather than fancy architecture.
- Safety and accessibility so that teachers and students can concentrate on teaching and learning.
- Using technology in curriculum-rich ways so that our students are “tech savvy” and prepared for a global economy.
- Teaching that emphasizes research-based, best practices in the digital age.

Our plan will result in an alternative high school that is secure, open, flexible and uses energy more sustainably than the current building.

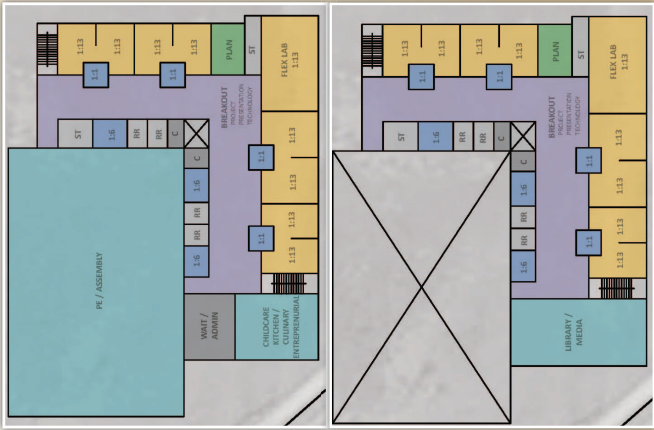

OUR TEAM'S RECOMMENDED OPTION

OPTION S-2 START OVER:

- Construct new school on District property, which may include the current school site.

SECURITY

Modify facility to create obvious main entry, secure waiting area and ability to observe visitors approaching the building. Subdivide the building into secure zones with electronically activated door closers.

TECHNOLOGY

Develop high-speed/high-volume fiber optic distribution to breakout spaces for projects, presentations and technology in each learning community, enhanced with robust wireless and hard-wired access points.

ENVIRONMENT

Install barn doors and garage doors with quality acoustical materials between learning areas and breakout areas for projects, presentations and technology. Create small learning communities for teams of teachers and students that include traditional classrooms as well as important support spaces for 1:1 tutoring, small groups, planning centers, storage, etc.

FACILITIES STRATEGIC PLAN

Site Area: 2.37 acres  
Parking Spaces: 60  
Building Square Footage  
Existing: 23,096  
New: 27,000  
Estimated Project Budget: \$5,921,603\*  
Remaining Deferred Maintenance & Energy Project Costs: \$0  
Rental / Lease / Sale Income: None  
Current Enrollment: 150  
Future Peak Enrollment: 150-250  
Capacity: 250

\*All costs are projected based on industry averages for building costs, sizes and land prices. Final project budget will be developed during the design phase.



## NOW IS THE TIME TO INVEST IN SMARTER SCHOOLS

Education has never been more important than it is today. Our students face international competition for scholarships and jobs, and an increasing pace of change that impacts their futures. Yet, while the need for quality education continues to increase, our schools are physically in decline.

At Missoula County Public Schools, we realize that we must change if we're to keep up academically and economically as a community. That's why we launched Smart Schools 2020. Led by teams from each school, the initiative assesses needs by facility and prioritizes those needs in light of achieving our goals of a 21st Century Educational Culture and of being fiscally responsible.

By addressing schools now we prevent further deterioration of facilities, better prepare for population growth and ensure our students continue to get the educational opportunities they need to succeed in school and beyond.

## THE SMART SCHOOLS PROCESS

### **SCHOOL CENTRIC:**

Criteria and preferred options were established for each school by a team of teachers, administrators, students and parents from that school, along with members of the Missoula community.

### **COLLABORATIVE:**

Alternatives were shared at public meetings at each school. In addition, surveys were sent out systemwide to vet priorities.

### **REALISTIC:**

Team recommendations were reviewed by the steering committee and the elected board of trustees before a bond measure was drafted.

### **PUBLIC:**

Everyone is invited to review options and weigh in. Final support for the initiative will be determined by public election in November 2015.



To get involved, please visit [www.mcpsmt.org/willard](http://www.mcpsmt.org/willard) or contact Principal Jane Bennett at [jabennett@mcps.k12.mt.us](mailto:jabennett@mcps.k12.mt.us).